

HIGHWAY 166/BLACK ROAD

TRAFFIC SIGNAL AND SAFETY IMPROVEMENT PROJECT

PROJECT OVERVIEW



Intersection of Highway 166 and Black Road between Santa Maria and Guadalupe in the unincorporated area of the County of Santa Barbara.



July 2024 to December 2024
The overall construction duration is anticipated to be five (5) months.



Safety and Efficiency Improvements

Major upgrades at the intersection to improve traffic flow and safety. The project features a new traffic signal system, dedicated turning lanes, improved lighting, reflective pavement markings, and enhanced drainage and flood control.

CONSTRUCTION TIMELINE

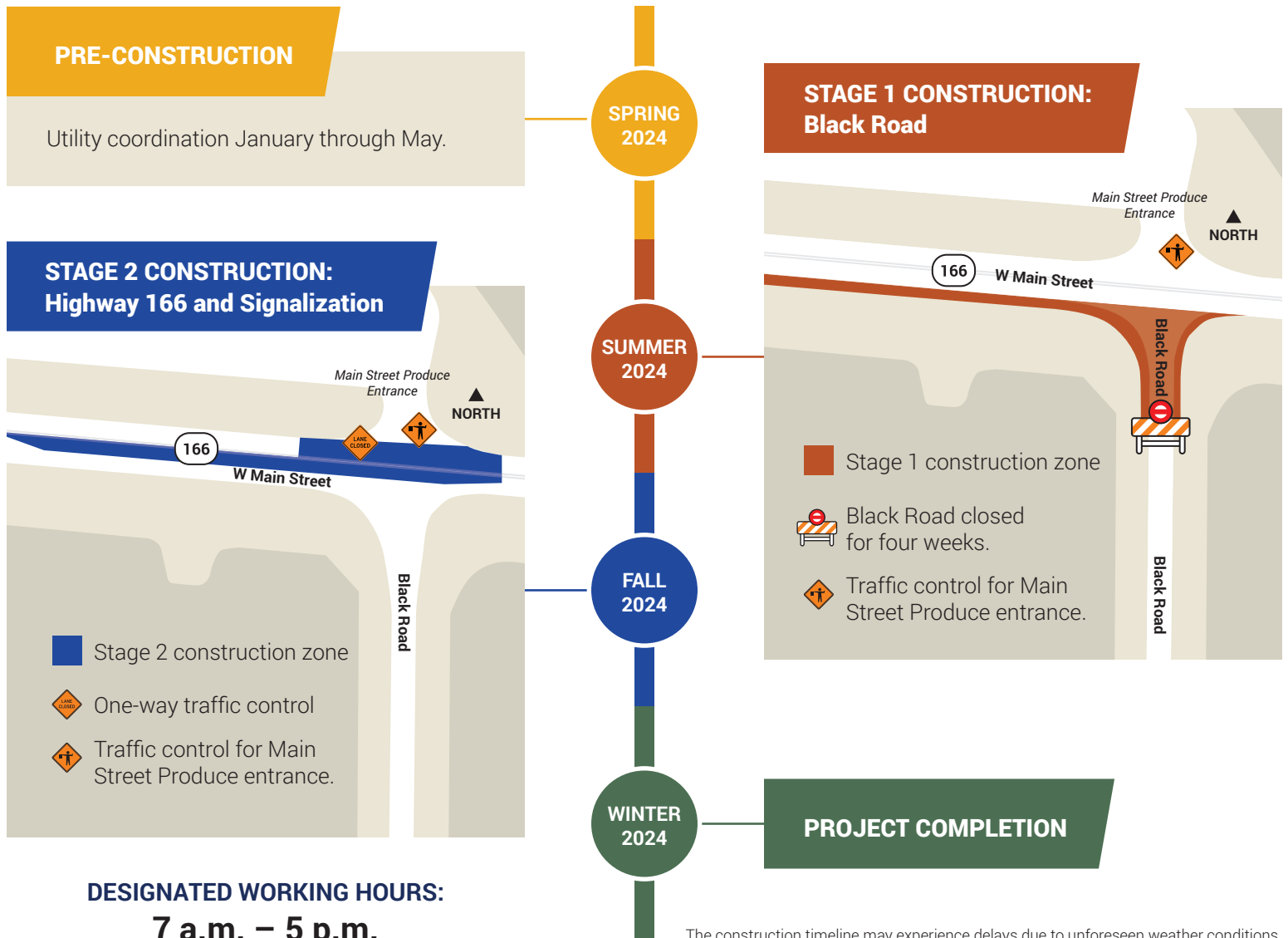

DETOUR ROUTE MAP

FROM GUADALUPE TO SANTA MARIA:





Take Ray Road to Sinton Road and continue onto Betteravia Road. To return to Highway 166, use S. Blosser Road as the quickest and most efficient way from Betteravia Road.

FROM SANTA MARIA TO GUADALUPE:

Take S. Blosser Road to Betteravia, continue on to Sinton Road and finish the detour on Ray Road to access Highway 166.



LEGEND:

-  Construction zone
-  Road/motor vehicle detour
-  Road closure: July, four (4) weeks
-  Bicycle/ pedestrian detour

COST

The SBCAG Board of Directors approved \$2.53 million from Measure A, Santa Barbara County transportation sales tax, to fund construction. This is one of four Measure A funded projects on Highway 166 to improve safety and operations.



PROJECT PARTNERS

SBCAG
Caltrans
City of Guadalupe
City of Santa Maria
County of Santa Barbara



Psomas
Rincon Consultants



MNS Engineers Inc.
Granite Construction

